

Battery Socket

SPECIFICATIONS

Current Rating:
2Amps
Voltage Rating:
250V
Insulator resistance:
1000 Megohms Min.
Contact Resistance:
20m ohms Max
Operating Temperature:
-40°C - +125°C
Contact Material:
Brass
Insulator Material:
LCP UL 94V-0
Color: Black
Finish:
4u" Gold plated

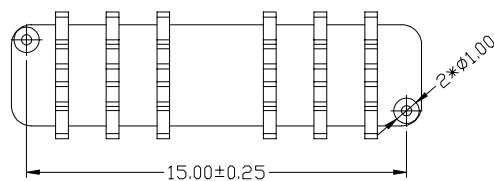
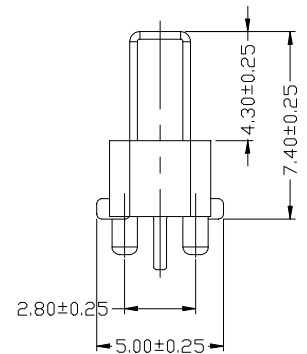
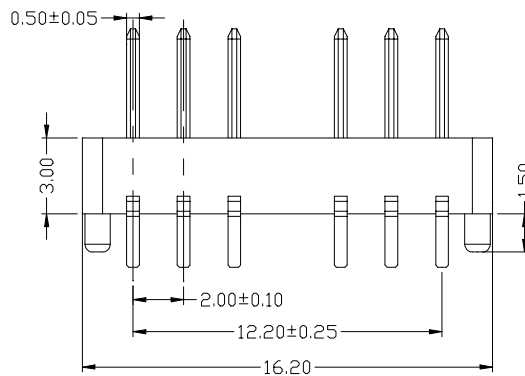
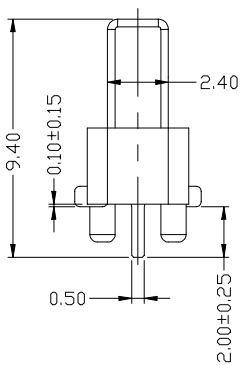
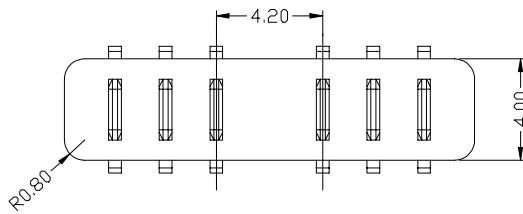
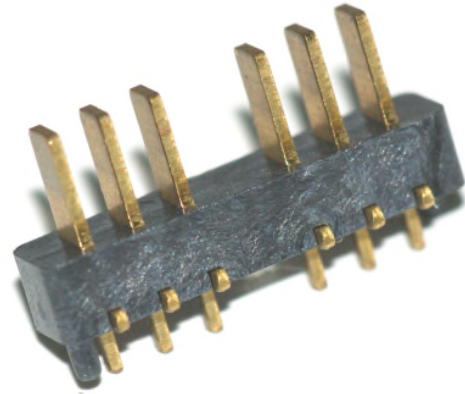

L 2 0 0 6 - 0 6 S 1 P X - 0 4 X

Insulator material
N: Nylon-6T
B: PBT
L: LCP
D: NY66

Number of Contact

Color

Appearance of pin header
S1P: Straight(带导柱)
D10: Right angle
MOP:SMT

Plating material
G Gold Plated
T Tin Plated
H Duplex Plated

Plating thickness
01 Normal
04 4u"
15 15u"